

MAKE AN IMPRESSION

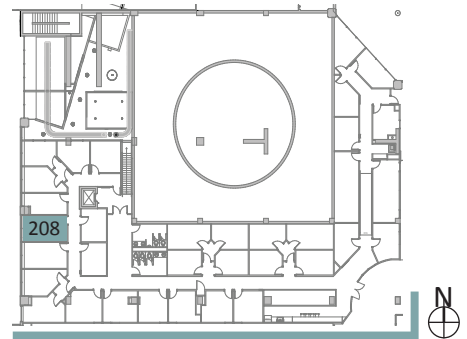

2ND FLOOR KEYPLAN

## OFFICE 208

186 SF

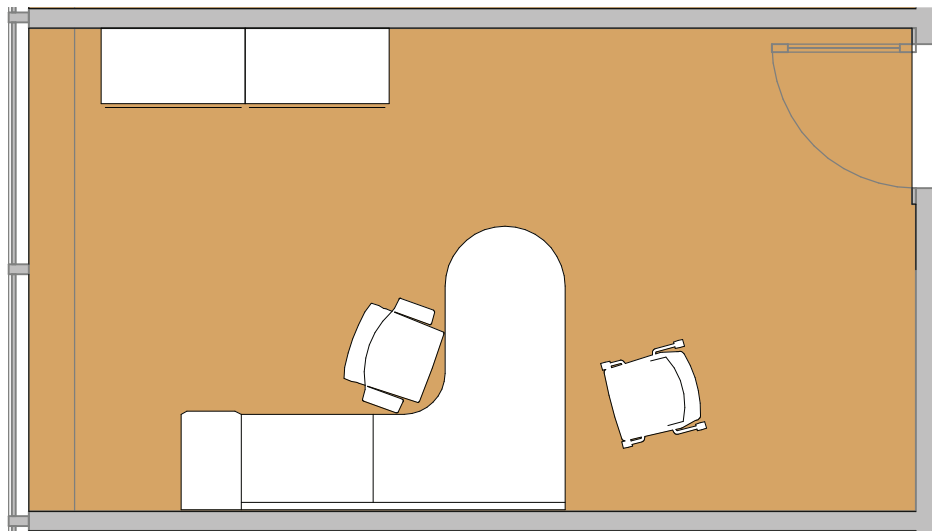

### ALL INCLUSIVE LEASE:

- STREET LEVEL AND SKYWALK LEVEL ENTRY
- FULLY FURNISHED
- HIGH SPEED INTERNET
- IN HOUSE PRINTING
- WEEKLY CLEANING SERVICES
- INDIVIDUAL STORAGE
- SECURE ACCESS
- PARKING IN ADJACENT RAMP
- USE OF COMMON SPACES; BOARDROOMS, LOUNGE, AND COFFEE BAR
- INDIVIDUAL USPS BOX AND PARCEL BOX